



The bridge to possible

Common Site-Survey Mistakes in Hospitals, Warehouses, Offices and ... Palaces!

Magda Romanowicz

Consulting Engineer

June 2022

What's coming up?



Spotlight Awards



Get recognized by the Cisco Community
New Awardees every month!

April winners: [Spotlight](#)

Stand out for your effort and commitment helping other members. Spotlight Awards highlight outstanding members. Be the next recipient!

Now you can also nominate a candidate!

[Click here](#)

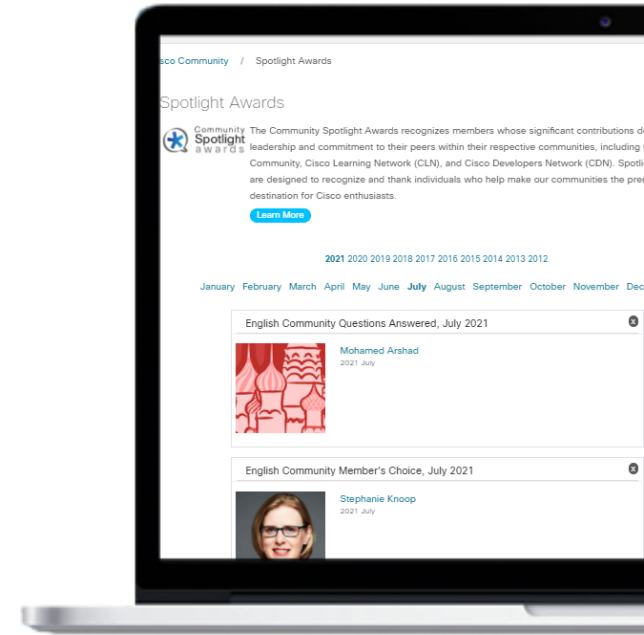

Connect, Engage, Collaborate!

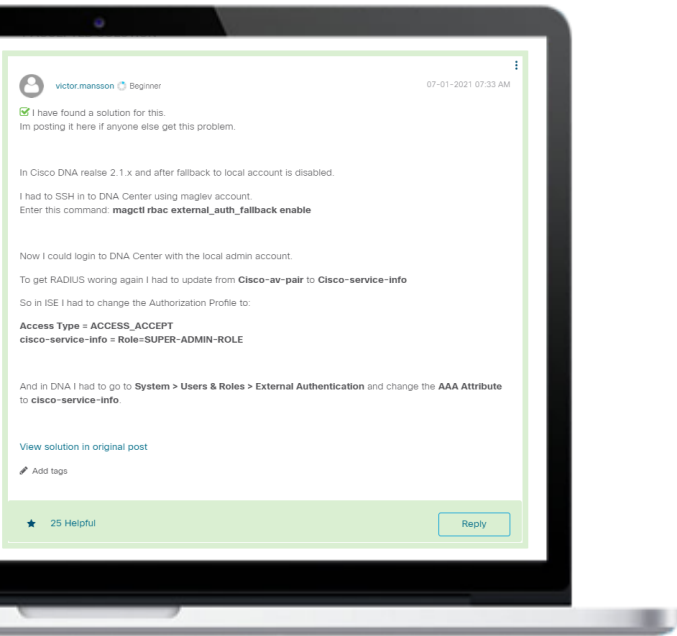

When you ask a Question and receive a correct Answer, **accept it as a solution!**

That helps other users find correct answers.

Accept as Solution

We all are sensitive to be highlighted.

Helpful votes motivate enthusiastic members by giving them a **token of recognition!**



25 Helpful

Our Experts



Magda
Romanowicz
Presenter



Kasia
Prusak
Question Manager



Download
the Presentation!

Common Site-Survey Mistakes in Hospitals, Warehouses, Offices and ... Palaces!

Magda Romanowicz
Consulting Engineer
21.06.2022



Who am I?

- Wireless Network Consulting Engineer
- Cisco Krakow
- Enterprise Wireless Design Specialist
- Site-survey Enthusiast
- Travel Lover



Agenda List

- 1 Site-Surveys Review
- 2 Common Mistakes
 - Where Everything Starts?
 - Importing Options
 - The Way You Walk Matters
 - Sell as Much as You Can
 - Stop! Freeze!
 - Be Closer
- 3 Is It Really a Mistake?
- 4 Summary

Polling Question 1

Do you have experience with
the site-surveys?

- Yes
- A little
- No



What kind of site-surveys
will be discussed?





Predictive Site-Survey

Pre-deployment Site-Survey





Post-deployment Site-Survey

ALL OF THEM!

- Predictive site-survey
- Pre-deployment site-survey (AP-on-the-stick)
- Post-deployment site-survey (validation of the new deployment)



Let me take you for the
journey ... through mistakes



Where Everything Starts?

#

1

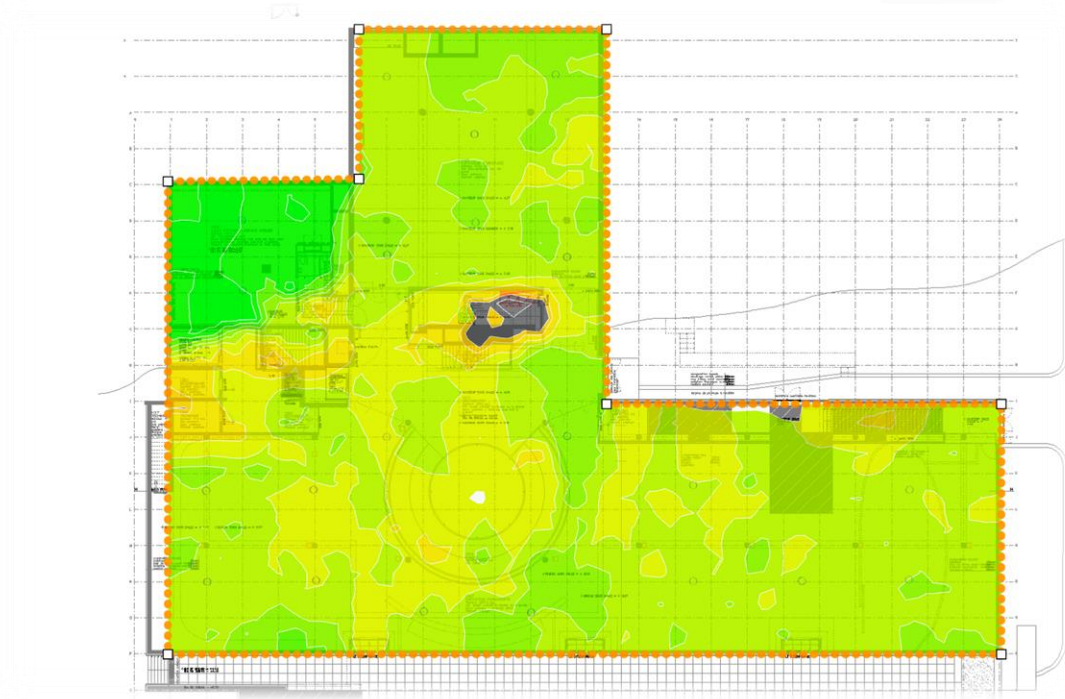

View as: Measured | Ekahau Best Practices (dBm)

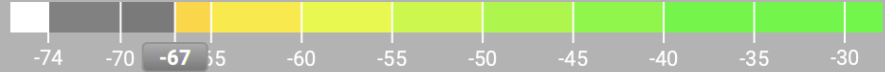

Best Practices in Reality

#

1

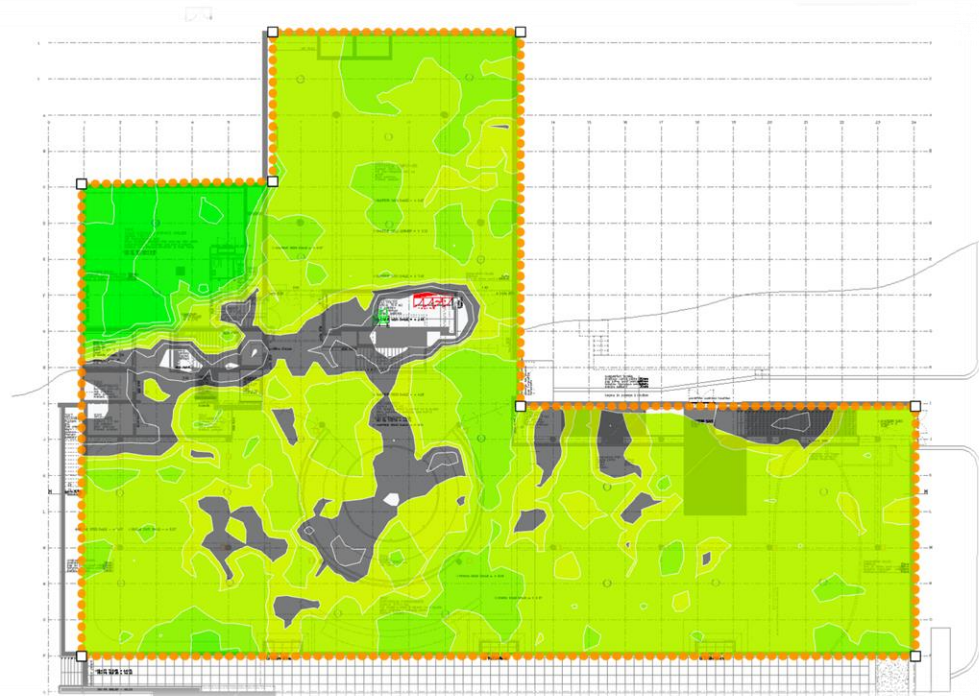

View as: Measured | Ekahau Best Practices (dBm)

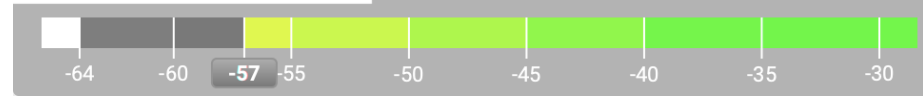

Threshold Changes Everything!

1



The scale should be adjusted to the weakest device



While performing the site-survey with Ekahau Sidekick, change in the scale is essential. The table below presents Sidekick Offset for sample devices

Device	2.4 GHz	5 GHz
Galaxy S10	-9 dB	-13 dB
iPhone X	-13 dB	-10 dB
Macbook Pro 15 2018	-5 dB	-3 dB

Based on: <https://rssicompared.com/offsets/ekahau>

Find 5 Differences

#2

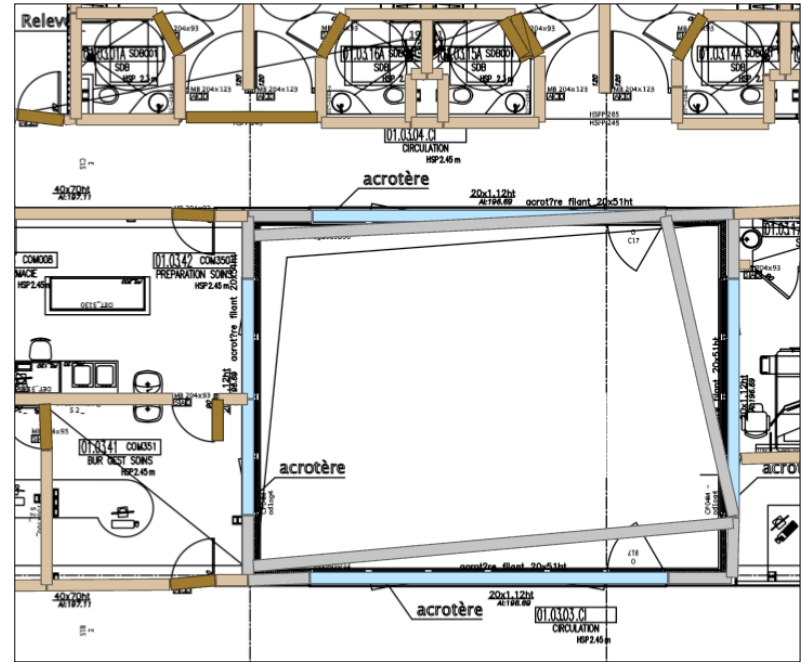
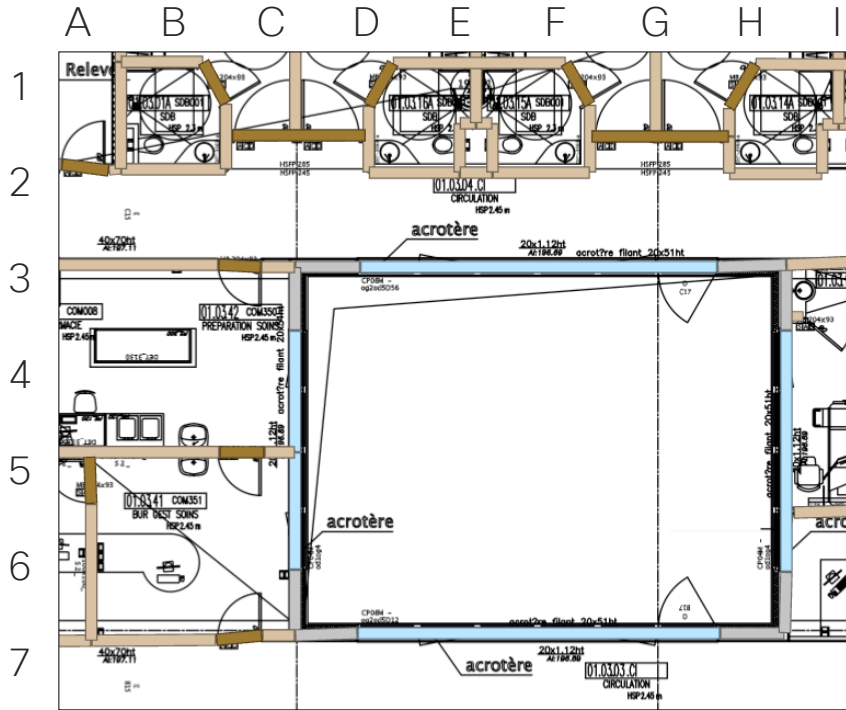

Importing Options

#2

- ✓ Ekahau software allows importing the floor plans from different sources, eg. Cisco Prime Infrastructure
- ✓ It is also possible to import additional layers, for example walls, doors, cubicles, etc.
- ✓ Not accurate floor plan drawing can lead to huge mistakes in the AP placing in predictive site-survey

The Way You Walk Matters

#3

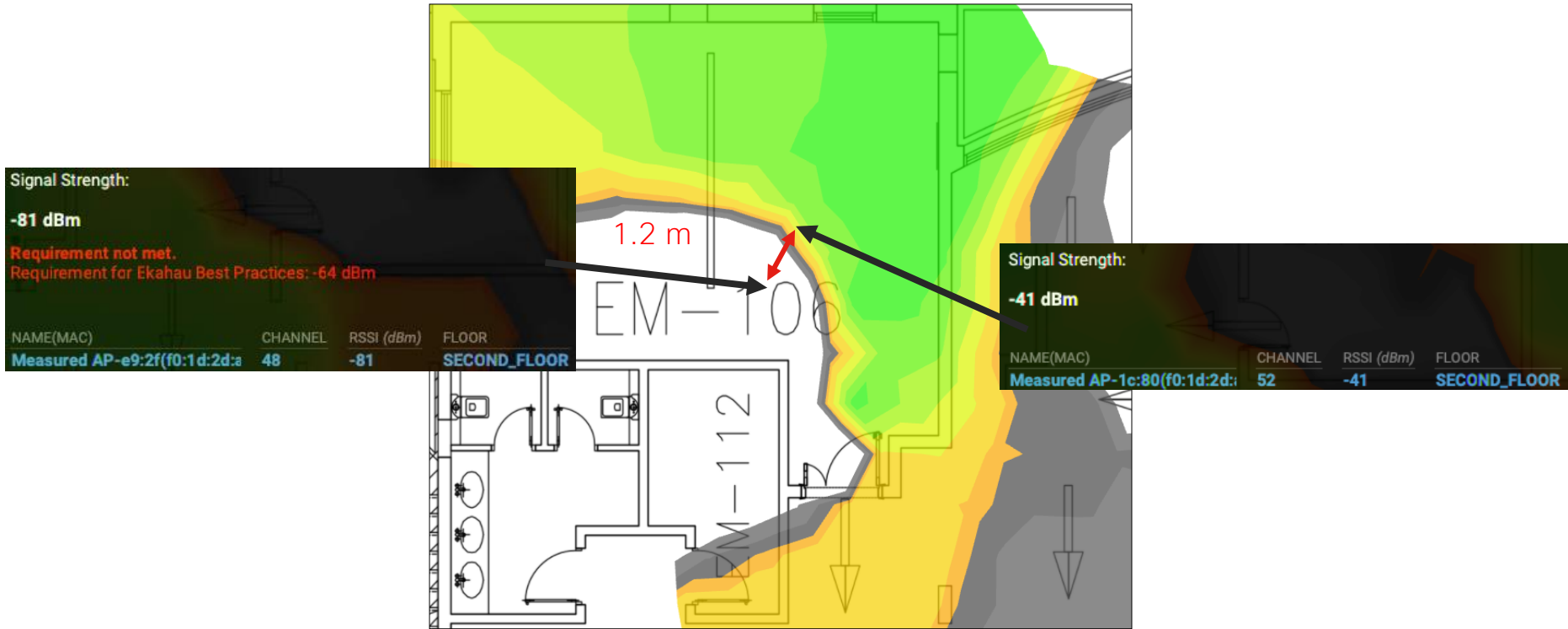

The Way You Walk Matters

#3

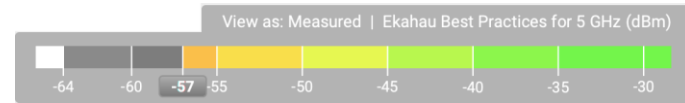
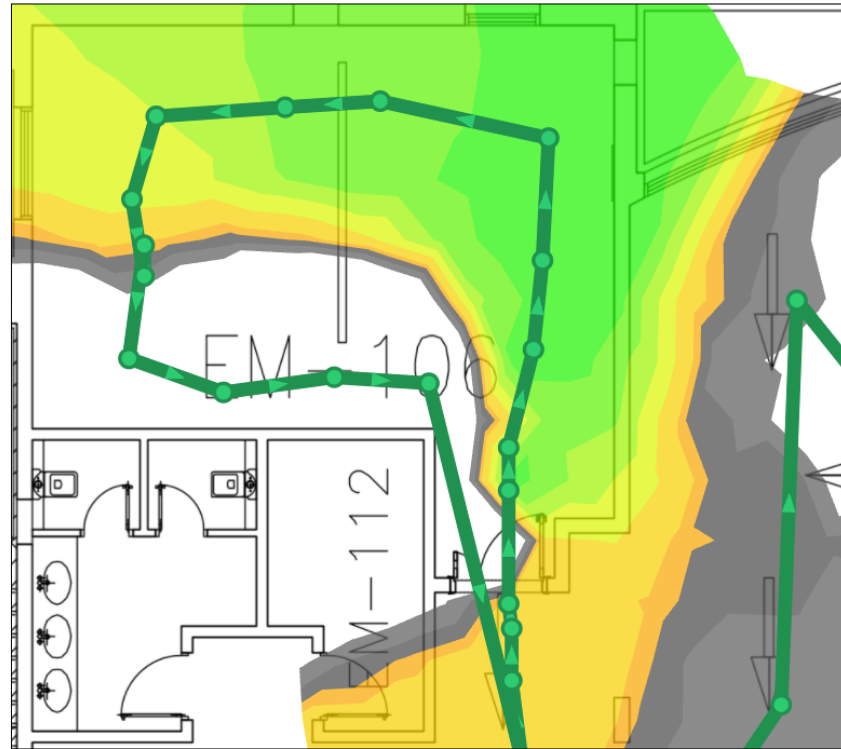

The Way You Walk Matters

#3

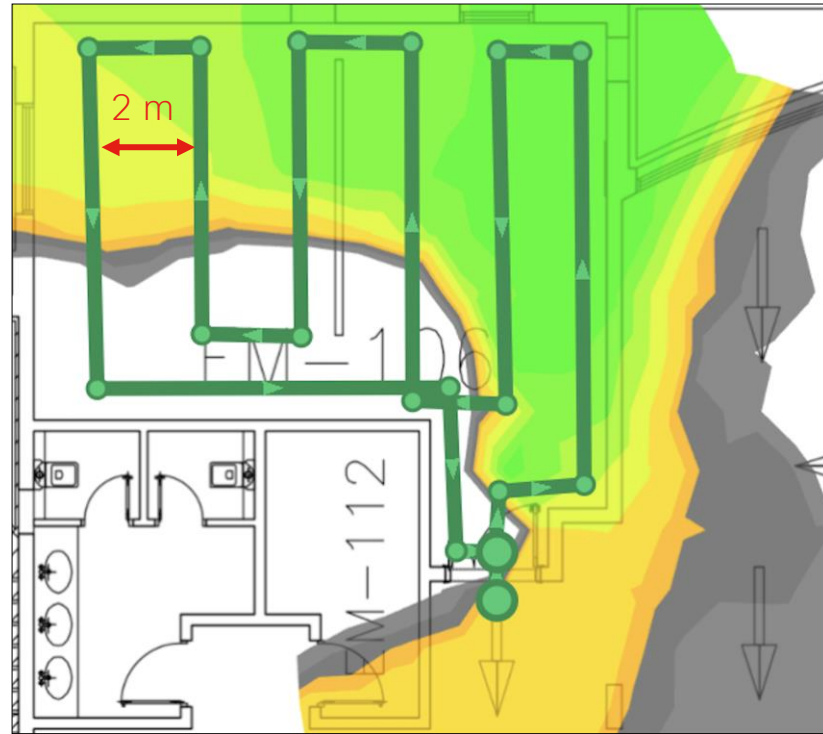

Summary

#3



Ensure scanning channels are tuned to optimize survey. Enable all channels allowed in the country only to check rogue APs and ad-hoc networks



Draw your path precisely



Walk slowly with steady speed



The distance between two paths should be around 2 m (it depends on the wireless adapter)



Skip only areas with similar environment and known signal's behaviour

Sell as Much as You Can

#4

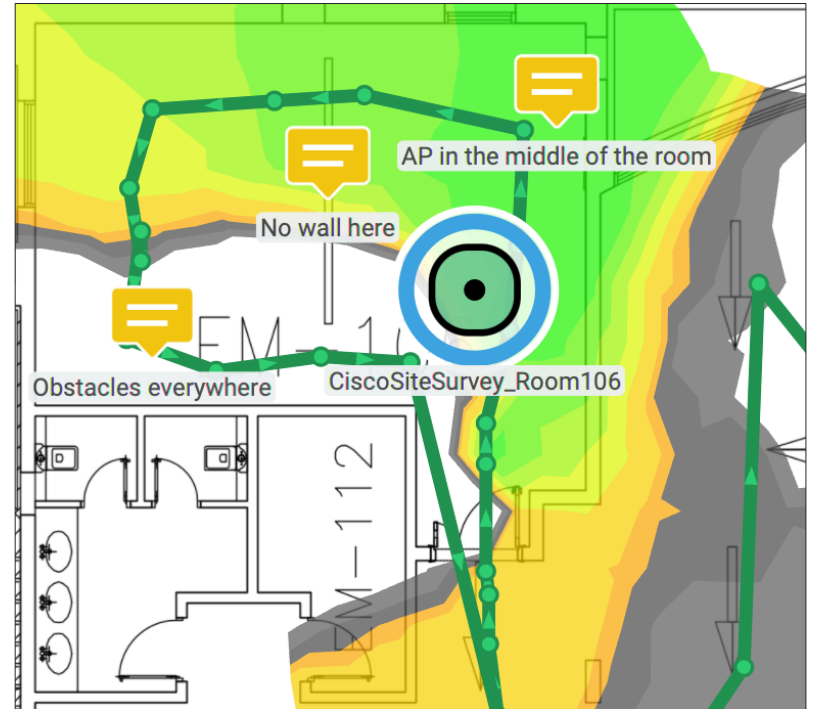
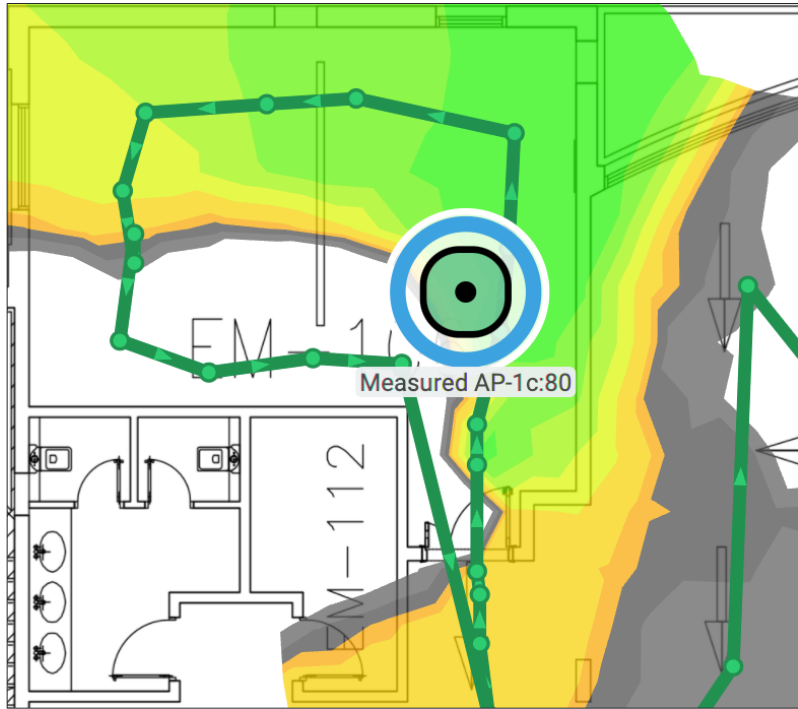

Summary

#4

- ✓ The files with site-surveys are usually used by more people than just the authors
- ✓ They should be detailed, include the notes, pictures of the testing AP positions and APs should have meaningful names
- ✓ Spending time on trying to understand the site-surveys is simply the waste of time

Stop! Freeze!

#5



Summary

#5



The Freeze Access Point tool allows a single access point that has been placed in several locations to be treated as multiple access points



While doing pre-deployment site-survey it is very important to freeze every validated AP

Be closer

#6



Summary

#6



Wi-Fi is designed to serve clients



APs should be located close to the future users



There should be a close work between an engineer and future users, designers, local contacts to find the most optimal AP positions

Polling Question 2

Which type of the mistake you realize you did in the past?

- #1 Threshold
- #2 Importing Options
- #3 Walking Path
- #4 Documentation
- #5 Freezing APs
- #6 Design



Bonus: Palace, Palazzo, Palais, ... Best Practices versus Real Life Deployments







Hidden Closets

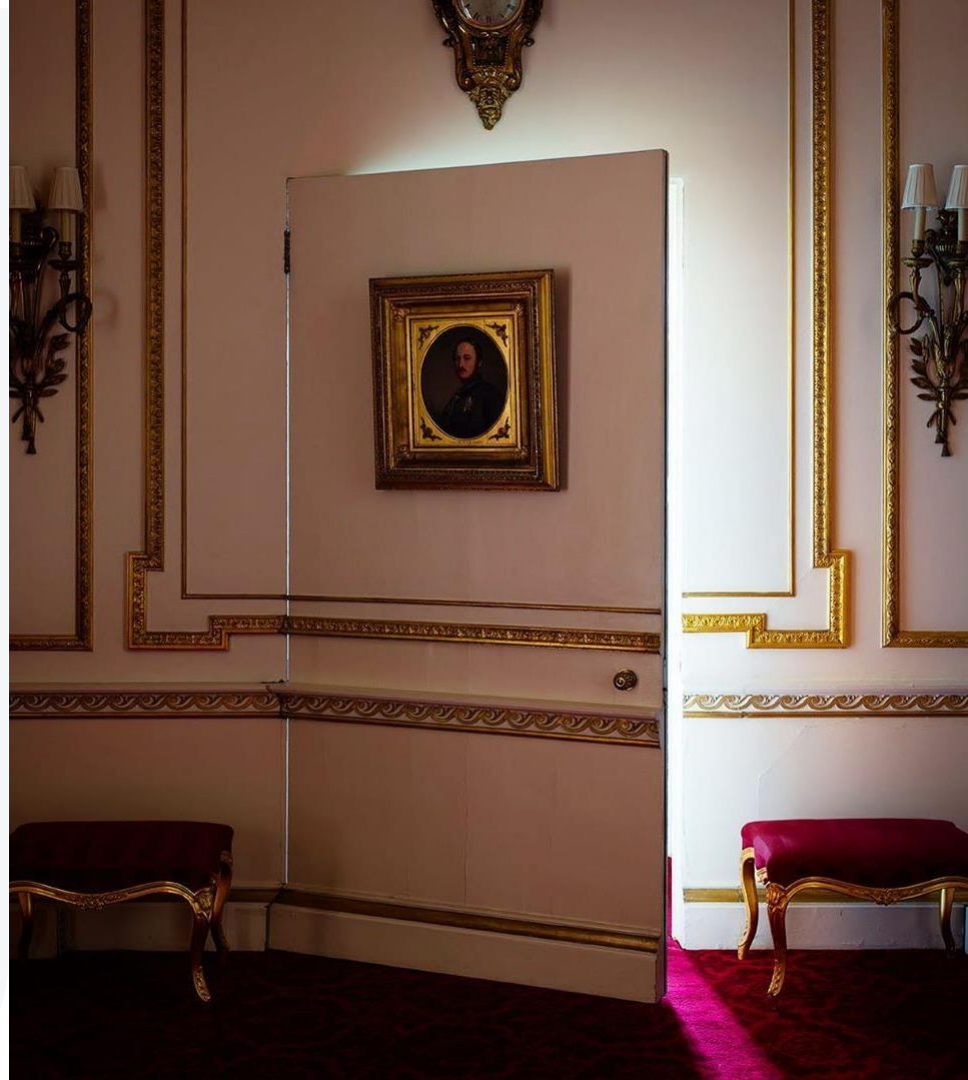



Do not be very strict to the Cisco Best Practices regarding placing APs. Once the solution is surveyed and validated it is free to go ;)

Lessons Learnt



To Be Remembered after This Session



Best Practices – do I understand them? Do not stick to the *best practises/golden rules* without validation



Put yourself in the shoes of the users



Be careful with the shortcuts



Prepare the detailed documentation so someone who will do the installation could understand

Polling Question 3

Do you have any other examples of the most common mistakes in site-surveys?



Questions?



CX Cisco
Customer Experience





Do you still have questions?

Use the "Q&A" panel

Forum Ask Me Anything

Find our expert on the Discussion Forum

Any new questions on the topic of this webinar will be answered thereafter until next week: July 1, 2022



Submit a new Question

Are you a New Member? Ask all your questions before the end of the month and maybe you will become the next Spotlight Awardee!

Wherever you are, stay connected ...

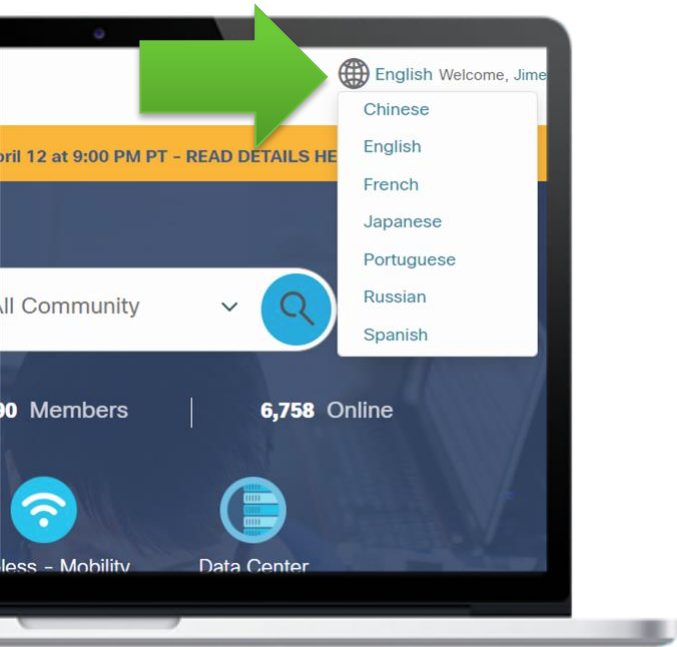

- Facebook [CiscoSupportCommunity](#)
- Twitter [@cisco_support](#)
- YouTube [CiscoSupportChannel](#)
- LinkedIn [Cisco Community](#)
- Instagram [CiscoSupportCommunity](#)

A low-angle photograph of a man in a business suit and tie, looking down at a tablet computer. He is standing in an urban environment with a large stone archway on the left, a classical stone fountain in the foreground, and modern buildings in the background. The sun is bright, creating a lens flare effect. The text "Do you have any Comments? Take our Survey!" is overlaid in the upper center of the image.

Do you have any Comments?
Take our Survey!



The bridge to possible